

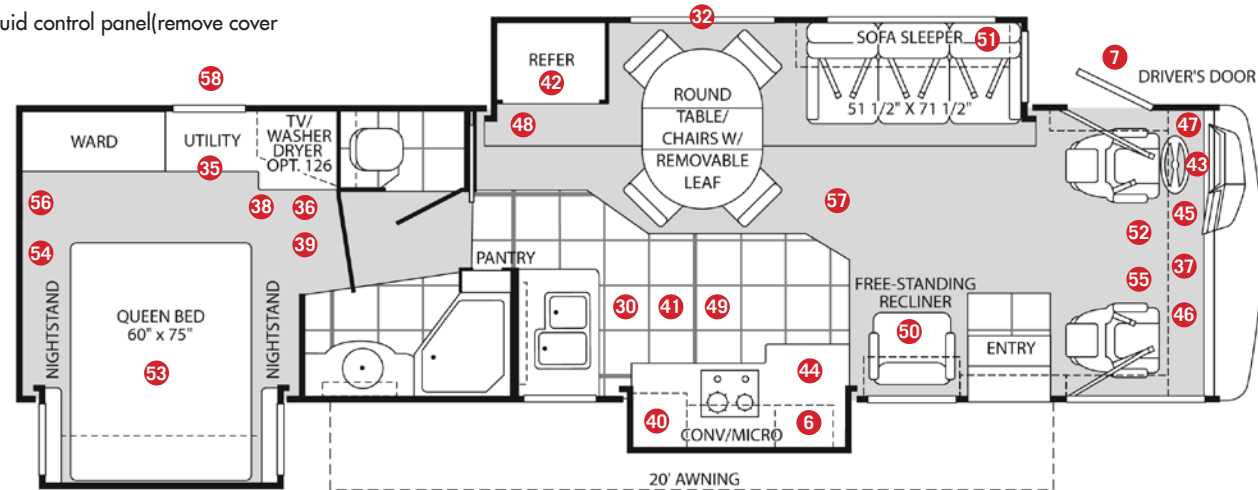

**CERTIFIED  
SECURE  
IDENTIFICATION**

5212 - 48th Street  
B102 - Suite 435  
Red Deer, AB T4N 7C3  
Phone: 1-877-CSE-IDOT  
Fax: 403-346-1911  
Email: info@csi-dots.com  
Web: www.csi-dots.com



Other \_\_\_\_\_

- Motor Home BRONZE**
- 1 \_\_\_ headlight housing
  - 2 \_\_\_ signal light
  - 3 \_\_\_ front grill
  - 4 \_\_\_ engine housing
    - \_\_\_ engine serial # plate
    - \_\_\_ engine fire wall
    - \_\_\_ alternator
    - \_\_\_ air-conditioning compressor
    - \_\_\_ radiator
  - 5 \_\_\_ wheels(outside & inside)
  - 6 \_\_\_ storage doors(inside)
  - 7 \_\_\_ drivers door
  - 8 \_\_\_ entrance door
  - 9 \_\_\_ awning arms
  - 10 \_\_\_ water heater
  - 11 \_\_\_ front/rear bumpers
  - 12 \_\_\_ front differential
  - 13 \_\_\_ steering arms
  - 14 \_\_\_ shocks
  - 15 \_\_\_ leveling jacks
  - 16 \_\_\_ oil pan
  - 17 \_\_\_ transmission
  - 18 \_\_\_ drive shaft
  - 19 \_\_\_ rear differential
  - 20 \_\_\_ axels
  - 21 \_\_\_ water holding tanks
  - 22 \_\_\_ fuel tank
  - 23 \_\_\_ motor coach frame(Both sides)
  - 24 \_\_\_ furnace compartment
  - 25 \_\_\_ generator compartment
  - 26 \_\_\_ water heater compartment
  - 27 \_\_\_ gray/black water dump compartment
  - 28 \_\_\_ propane bottles
  - 29 \_\_\_ propane bottle housing
  - 30 \_\_\_ storage compartments (inside)
  - 31 \_\_\_ steps
  - 32 \_\_\_ slide outs
  - 33 \_\_\_ spare tire & mounting bracket
  - 34 \_\_\_ brakes
  - 35 \_\_\_ plumbing lines

- Motor Home SILVER**
- 36 \_\_\_ televisions
  - 37 \_\_\_ stereos
  - 38 \_\_\_ DVD/VCR
  - 39 \_\_\_ satellite dish receiver
  - 40 \_\_\_ microwave
  - 41 \_\_\_ oven
  - 42 \_\_\_ refrigerator
  - 43 \_\_\_ steering column
  - 44 \_\_\_ front seats(metal mounting frames)
  - 45 \_\_\_ back up monitor
  - 46 \_\_\_ AC Heat vents
  - 47 \_\_\_ gas/brake pedals
  - 48 \_\_\_ central air vents
  - 49 \_\_\_ drawers/cupboards(Underside)
  - 50 \_\_\_ reclining chairs(metal arms)
  - 51 \_\_\_ fold out sofa (metal arms)
  - 52 \_\_\_ fuse panel(remove cover)
  - 53 \_\_\_ bed frame
  - 54 \_\_\_ night stands(Inside drawers)
  - 55 \_\_\_ air vents
  - 56 \_\_\_ closets(inside)
  - 57 \_\_\_ light fixtures
  - 58 \_\_\_ temp/fluid control panel(remove cover)

MAKE \_\_\_\_\_ VIN# \_\_\_\_\_

MODEL \_\_\_\_\_ Additional Serial # \_\_\_\_\_